

## AM9 Series Moulded Case Circuit Breaker

### 1. Application

AM9 series MCCB is suitable for industrial or commercial power and lighting with AC50/60Hz, rated working voltage up to AC600V/DC250V, rated current up to 630A. It's a kind of economical breaker with the characters of stable and reliable function, beautiful appearance, small size and long life. It can be used for conversion of line and infrequent starting motor. It can also be attached to install the accessories which have protection function for avoiding loss-voltage, undervoltage. The product can install connection line with front board and back board, it also can equip hand-operating apparatus or motor-operating apparatus to control in a remote distance.



AM9-63S

### 2. Specification

The rated insulation voltage for this series of circuit breaker is 690V, the rated operating voltage is 600V, the rated frequency is 50Hz, the other rated values for the main circuit.



AM9-103S

Type	2pole	AM9-32E	AM9-52E	AM9-52S	AM9-62E	AM9-62S
	3pole	AM9-33S	AM9-53E	AM9-53S	AM9-63E	AM9-63S
Frame size(AF)		30	50		60	
Rated current(A)		5,10,15,20,30	5,10,15,20,30,40,50		60	
Rated operational voltage(V)Ue (50/60Hz)		600	600	600	600	600
Rated insulation voltage(V)Ui(50/60Hz)		690	690	690	900	900
Rated impulse withstand voltage(kV)Uimp		6	6	6	6	6
Ultimate breaking capacity (kA,Icu AC 50/60Hz)	220V/240V	10	10	25	10	25
	380V	7.5/5	7.5/5	14/10	7.5/5	14/10
	415V	7.5/5	7.5/5	14/10	7.5/5	14/10
	440/460V	5	5	10	5	10
	480/500V	2.5	2.5	7.5	2.5	7.5
	600V	2.5	2.5	5	2.5	5
Utilisation category		A	A	A	A	A
Endurance	Mechanical	8500	8500	8500	8500	8500
	Electrical	1500	1500	1500	1500	1500



AM9-203S

Type	2pole	AM9-102E	AM9-102S				
	3pole	AM9-103E	AM9-103S	AM9-203E	AM9-203S	AM9-403E	AM9-403S
Frame size(AF)		100		225		400	
Rated current(A)		5,10,15,20,30,40,50,60,75,100	15,20,30,40,50,60,75,100	100,125,150,175,200,225		250,300,350,400	
Rated operational voltage(V)Ue (50/60Hz)		600	600	600	600	600	600
Rated insulation voltage(V)Ui(50/60Hz)		690	690	690	690	690	690
Rated impulse withstand voltage(kV)Uimp		6	6	6	6	6	6
Ultimate breaking capacity (kA,Icu AC 50/60Hz)	220V/240V	10	50	35	50	35	50
	380V	7.5/5	25	18	25	30	42
	415V	7.5/5	25	18	25	25	35
	440/460V	5	25	18	25	25	35
	480/500V	2.5	25	10	14	18	25
	600V	2.5	14	7.5	10	18	22
Utilisation category		A	A	A	A	A	A
Endurance	Mechanical	8500	8500	7000	7000	4000	400
	Electrical	1500	1500	1000	1000	1000	1000



AM9-403S

## 3. Outline and Installation Dimensions

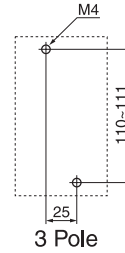
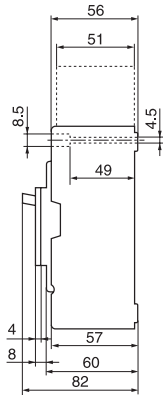
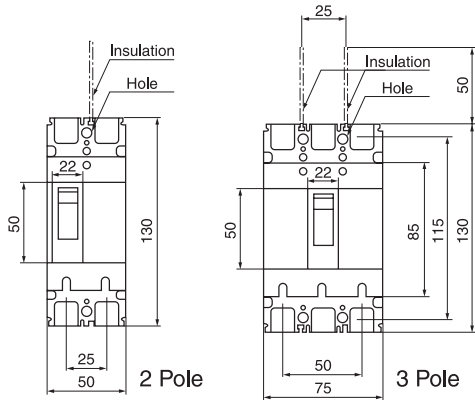

**AM9-30,50,60**

Diagram of terminal connection

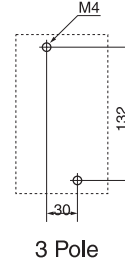
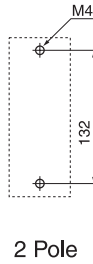
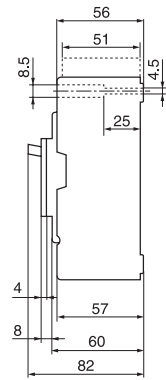
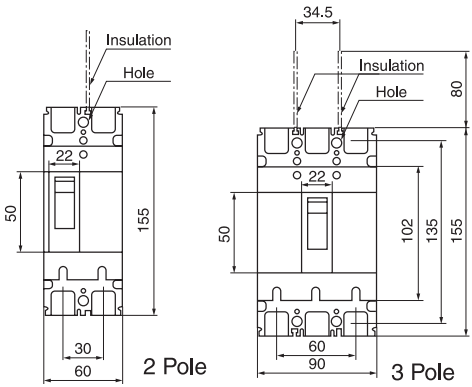
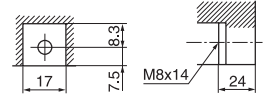

**AM9-100**

Diagram of terminal connection

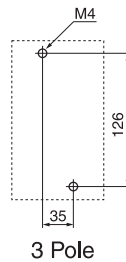
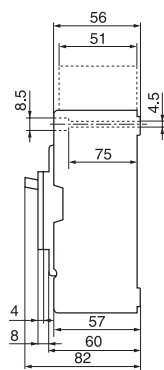
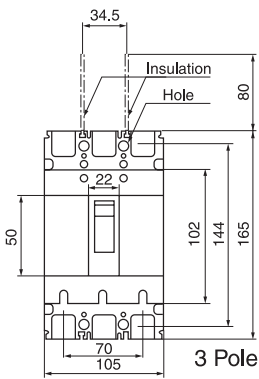
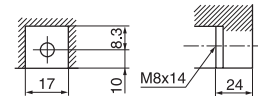

**AM9-225**

Diagram of terminal connection

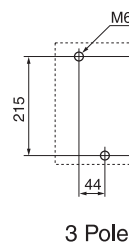
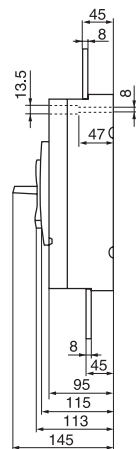
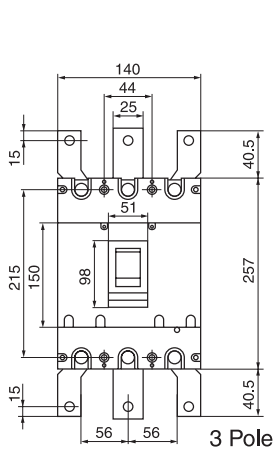
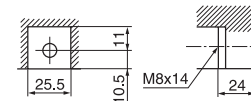

**AM9-400**

Diagram of terminal connection

